

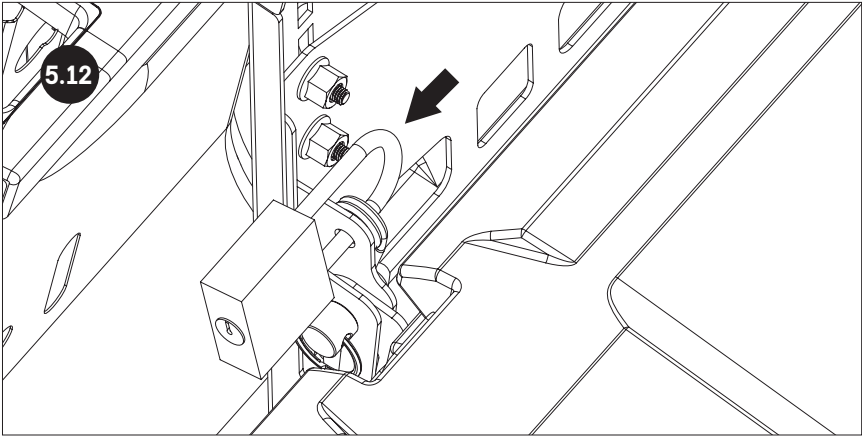

5 FIT & SECURE



FOR THEFT DETERRENCE, SECURE R-CLIP TO TRUNK CLAMP WITH PADLOCK (NOT INCLUDED) ON ONE OR BOTH SIDES OF TRUNK AS SHOWN.

6 INSTALLATION COMPLETE

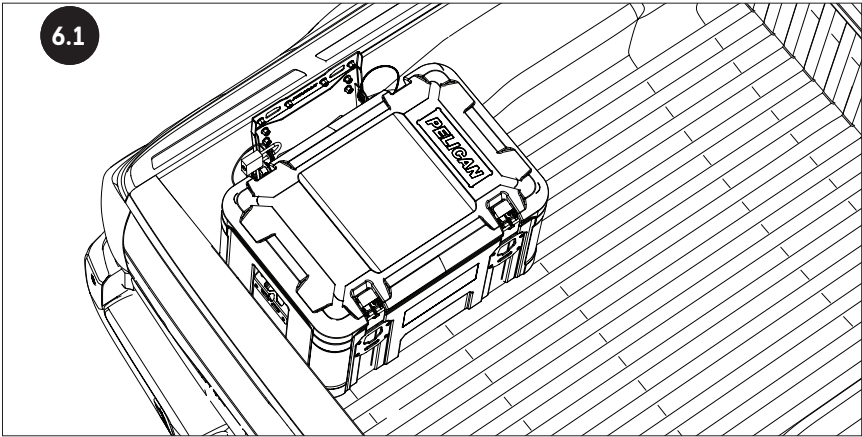

ENJOY YOUR NEW PELICAN™ CARGO CASE WITH SECURE MOUNTING.

CARGO CASE SIDE-MOUNTING KIT

TOYOTA™ RAIL

SINCE 1976

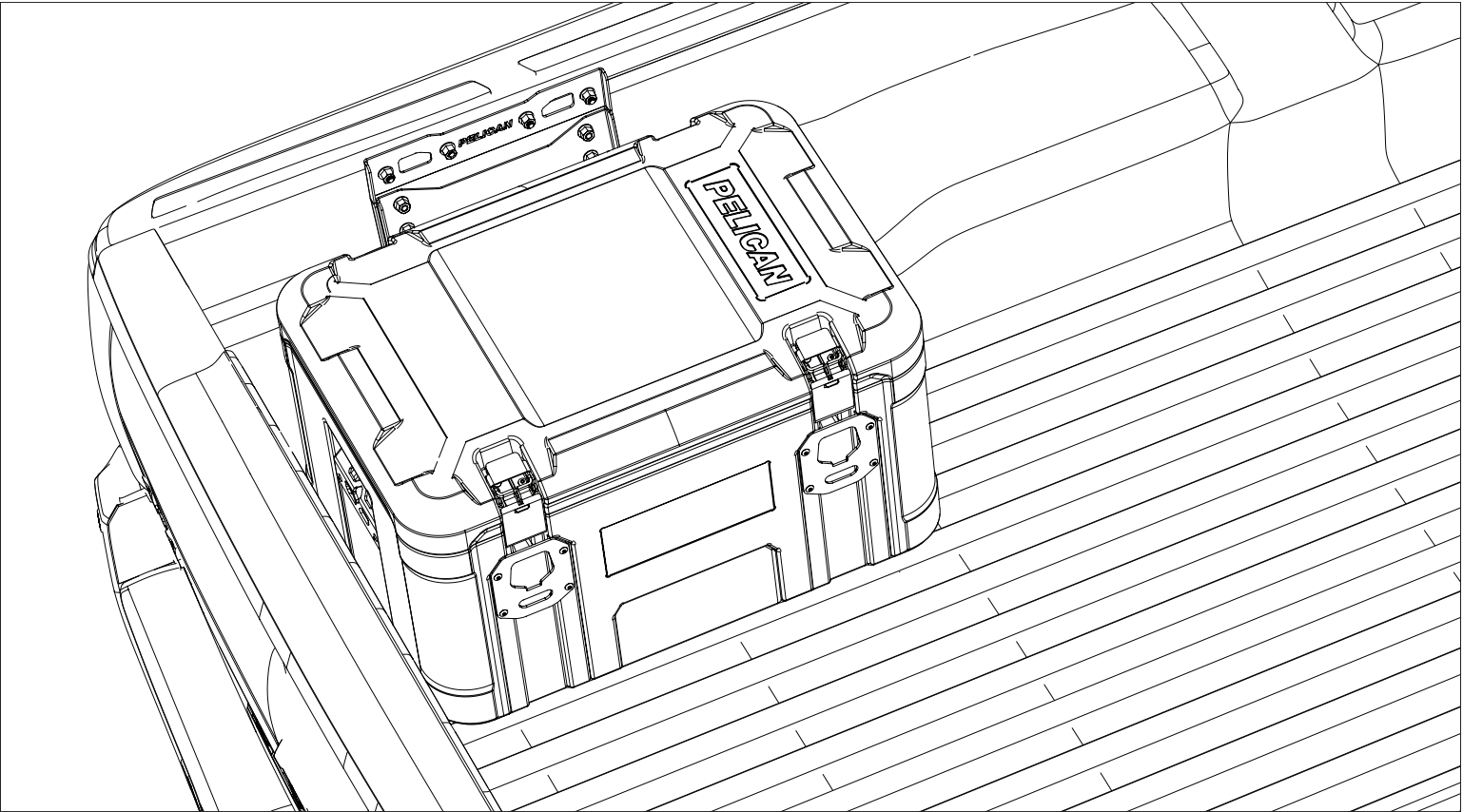

READ ME!

THANK YOU FOR PURCHASING A PELICAN™ CARGO CASE SIDE-MOUNTING KIT, FOR A TOYOTA™ RAIL STYLE TRUCK BED. BEFORE YOU START, TAKE A MOMENT TO FAMILIARIZE YOURSELF WITH THE FITTING INSTRUCTIONS AND THE COMPONENTS RECEIVED. REFER TO PAGE 2 FOR A LIST OF ALL THE COMPONENTS, QUANTITIES AND TOOLS REQUIRED.

- CARGO CUBE BX50 OR CARGO SMALL CASE BX80 MAY BE POSITIONED BEHIND OR IN FRONT OF WHEEL-WELL AS DESIRED, AS RAIL AND BED SPACE PERMIT.
- NOTE: CASE MAY BE MOUNTED ON HINGE OR LATCH SIDE, ACCORDING TO ACCESS PREFERENCE- FROM OUTSIDE OR INSIDE TRUCK BED.



IMPORTANT WARNING!

It is critical that the Pelican™ Cargo Mounts and Cases be properly installed and securely attached to your vehicle. Failure to properly secure the mounts and cases to your vehicle could result in serious injury and even death. You are responsible for the fitment of the mounts and Cargo Cases to your vehicle. You must therefore periodically inspect the equipment for wear and damage. Replace if in doubt. If you have limited mechanical experience you should not attempt to install the equipment. You should have the equipment installed by a professional installer if you have any doubts about your abilities.

It is imperative that the user check the security of the cases to the vehicle after an initial brief period of driving and adjust if required. Pelican recommends the user do so periodically and, if road conditions change (i.e. freeway to dirt road) again check the security of the attachment of the Case to the vehicle.



LATCHES AND MOUNTING KIT CARE

Periodically check the latches and mounting hardware to ensure there are no loose parts. Continual exposure to daylight may cause the black hardware finish to dull. To maintain the gloss finish, occasionally apply a light coat of UV protectant. After exposure to salty coastal climates or snowy regions, rinse off the mounts with water to remove salt deposits. To help prevent corrosion, apply a silicone-based oil or spray to nuts and bolts.

PELICAN™ CARGO CASES AND MOUNTS LIMITED LIFETIME WARRANTY (CASES) AND THREE YEAR WARRANTY (MOUNTS)

Pelican Products, Inc. ("Pelican") guarantees its Pelican™ Cargo cases for a lifetime against breakage or defects in workmanship. This lifetime warranty does not cover mounting hardware, which Pelican warrants against defects in materials and workmanship for three years from the date of purchase. To the extent permitted by law, Pelican's liability is limited to the case and not its contents and in no event shall Pelican's liability to the purchaser for damages exceed the purchase price of the case in respect of which damages are claimed.

TO THE EXTENT PERMITTED BY LAW: (A) THIS WARRANTY IS IN LIEU OF ALL WARRANTIES, EXPRESS OR IMPLIED, INCLUDING, BUT NOT LIMITED TO, THE IMPLIED WARRANTIES OF MERCHANTABILITY AND FITNESS FOR A PARTICULAR PURPOSE; (B) ALL OTHER IMPLIED WARRANTIES AND ANY LIABILITY NOT BASED UPON CONTRACT ARE HEREBY DISCLAIMED AND EXCLUDED; AND (C) IN NO EVENT SHALL PELICAN BE LIABLE FOR ANY INDIRECT, PUNITIVE, INCIDENTAL OR CONSEQUENTIAL DAMAGES, OR SPECIAL DAMAGES, REGARDLESS OF WHETHER A CLAIM FOR SUCH DAMAGES IS BASED ON WARRANTY, CONTRACT, NEGLIGENCE OR OTHERWISE.

With valid dated proof of purchase, Pelican will either repair or replace any broken or defective product, at our sole option. Certain products are available for a limited time only. If a claim is made involving one of these products, Pelican reserves the right to replace a broken or defective product with a standard Pelican product of comparable size and quality if no comparable limited edition product is available at the time of a claim. TO THE EXTENT PERMITTED BY LAW, THIS SHALL BE THE SOLE AND EXCLUSIVE REMEDY OF THE PURCHASER.

To make a warranty claim, the purchaser must complete the warranty claim form at <https://www.pelican.com/us/en/support/warranty/>. Any warranty claims shall be made by the purchaser as soon as practicable and, with respect to the mounts and related hardware, no later than three years from the date of purchase. The purchaser must provide valid dated proof of purchase and obtain a return authorization number from Pelican Customer Service prior to returning any product, and is responsible for paying for all warranty freight costs. If Pelican determines that any returned product is not defective, within the terms of this warranty, the purchaser shall pay Pelican all costs of handling, return freight and repairs at Pelican's prevailing rates.

This warranty does not cover normal wear and tear including but not limited to scratches, dents or tears, aesthetic surface damage which may be caused by oxidation or by the natural breakdown of colors caused by exposure to the elements. All warranty claims of any nature are barred if the product has been altered, damaged or in any way physically changed, or subjected to abuse, misuse, negligence or accident.

Some states and countries do not allow limitations on how long an implied warranty lasts or the exclusion or limitation of incidental or consequential damages, so the above limitation or exclusion may not apply to you. This warranty gives you specific legal rights, and you may have other rights which vary from state to state and country to country.

In Australia: The benefits provided to you under this warranty are in addition to your rights and remedies as a consumer under the Australian Consumer Law as contained in the Competition and Consumer Act 2010 (Cth) ("the Act"). Nothing in this warranty limits the rights or obligations of a party under the Act in relation to the supply to consumers of goods which cannot be limited, modified or excluded. If applicable, our goods come with guarantees that cannot be excluded under the Act. Consumers are entitled to a replacement or refund for a major failure and compensation for any other reasonably foreseeable loss or damage. Consumers are also entitled to have the goods repaired or replaced if the goods fail to be of acceptable quality and the failure does not amount to a major failure. If you are not a consumer under the Act, then your rights may be limited. To make a warranty claim, the purchaser may contact Pelican Products Australia, Suite 2.33, West Wing, Platinum Bldg., Erina NSW 2250, Tel: +612 4367 7022, or email: info.australia@pelican.com. Any claims should be made as soon as practicable. To expedite claims, the purchaser should obtain a return authorization number from Pelican Customer Service prior to returning any product. The purchaser is responsible for paying for all freight costs. If Pelican determines that any returned product is not defective, within the terms of this warranty or the Act, the purchaser may pay Pelican all costs of handling, return freight and repairs at Pelican's prevailing rates. In the event that Pelican determines that any returned product is defective, within the terms of this warranty or the Act, Pelican shall pay the purchaser all reasonable costs of the purchaser in making a claim under this warranty.

Lifetime warranty does not cover Vault by Pelican or Roto Molded cases or fabric portion of backpacks.

1 GET ORGANIZED

PARTS LIST

ITEM NO.	DESCRIPTION	QTY.
1	SIDE-MOUNT UPPER	1
2	SIDE-MOUNT LOWER	1
3	SIDE-MOUNT FOOT	1
4	(M8 X 16) CARRIAGE BOLT	8
5	(M8) LOCK NUT	12
6	(M8 X 30) CARRIAGE BOLT	4
7	RUBBER FOOT	2
8	(M5 X 16) SCREW	4
9	CLAMP A	1
10	CLAMP B	1
11	TETHERED PIN & R-CLIP ASSY	2
12	NUT PLATE	2
13	NYLON RETAINER WASHER	4

TOOLS REQUIRED*



13MM
8MM
SOCKET/WRENCH

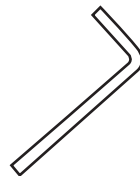

M3 HEX

* Tools not included.

5 FIT & SECURE

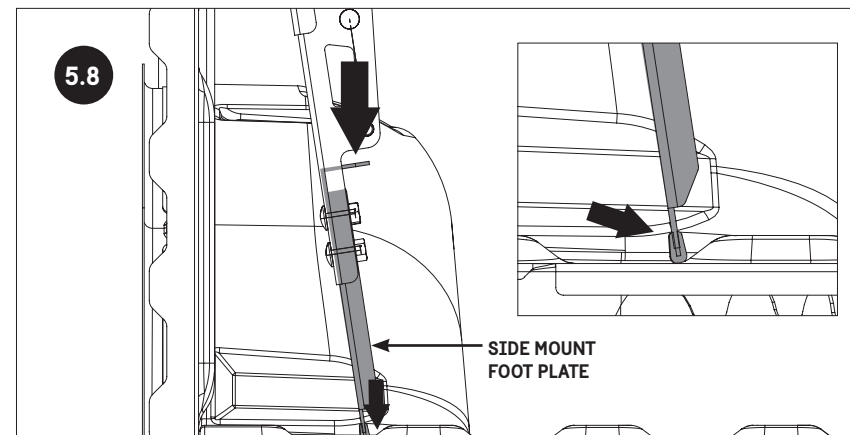

PUSH DOWN FIRMLY ON FOOT PLATE TAB TO SEAT FOOT INTO BED FLOOR, FOOT MUST CATCH ON EDGE OF BED RIB AS SHOWN.

IT IS OK TO SWING THE FOOT AND FLEX THE MOUNT MINIMALLY (PREFERABLY TOWARDS BED WALL) TO LINE UP WITH A FLOOR RIB.

NOTE: FLEXING TOO FAR EITHER WAY MAY CAUSE THE CASE TO NOT SIT FLAT ON FLOOR.

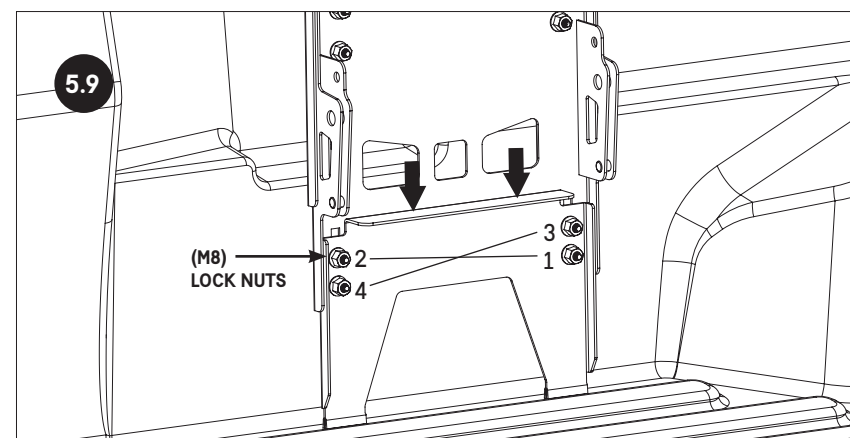

TIGHTEN FOUR (M8) LOCK NUTS ON FOOT PLATE WHILE PUSHING DOWNWARDS TO MAINTAIN GOOD FOOTING.

TIGHTEN BOLTS IN A SIDE TO SIDE PATTERN TO ENSURE EVEN SEATING OF BOTH FEET.

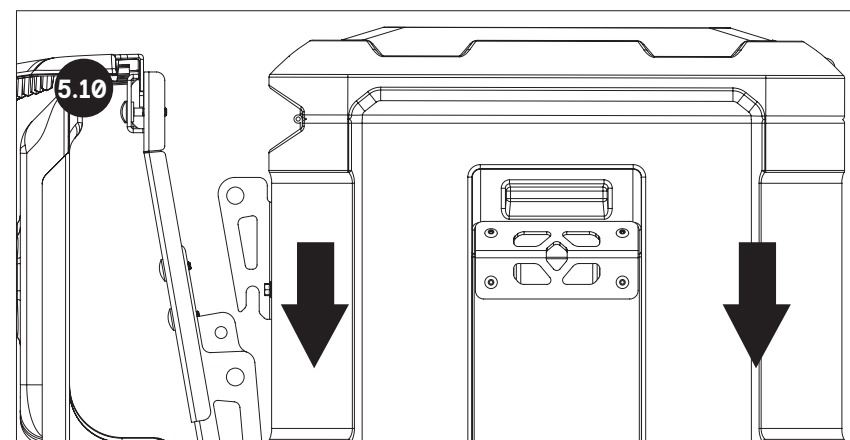

RE-INSTALL TRUNK BY LIFTING IT AND LOWERING CLAMP HOOKS ON TO THE LOWER MOUNT PINS.

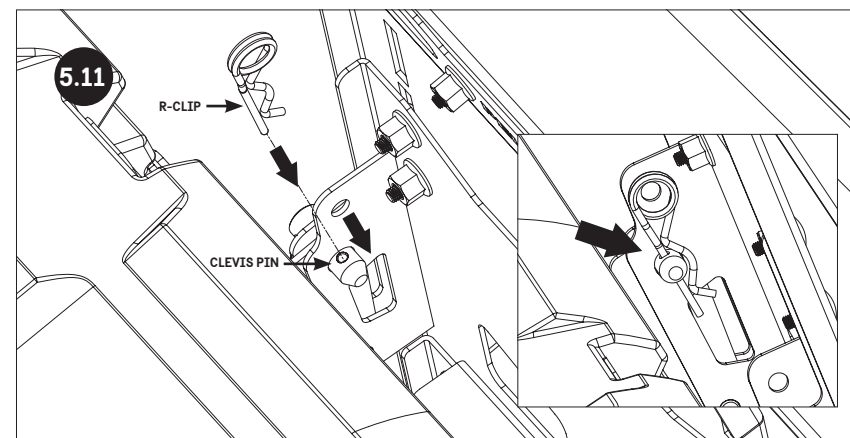

INSERT BOTH CLEVIS PINS SO THAT CLIP HOLES ARE INSIDE MOUNTING EARS AND FACING UPWARD.

NEXT INSERT BOTH R-CLIPS AS SHOWN.

1.1

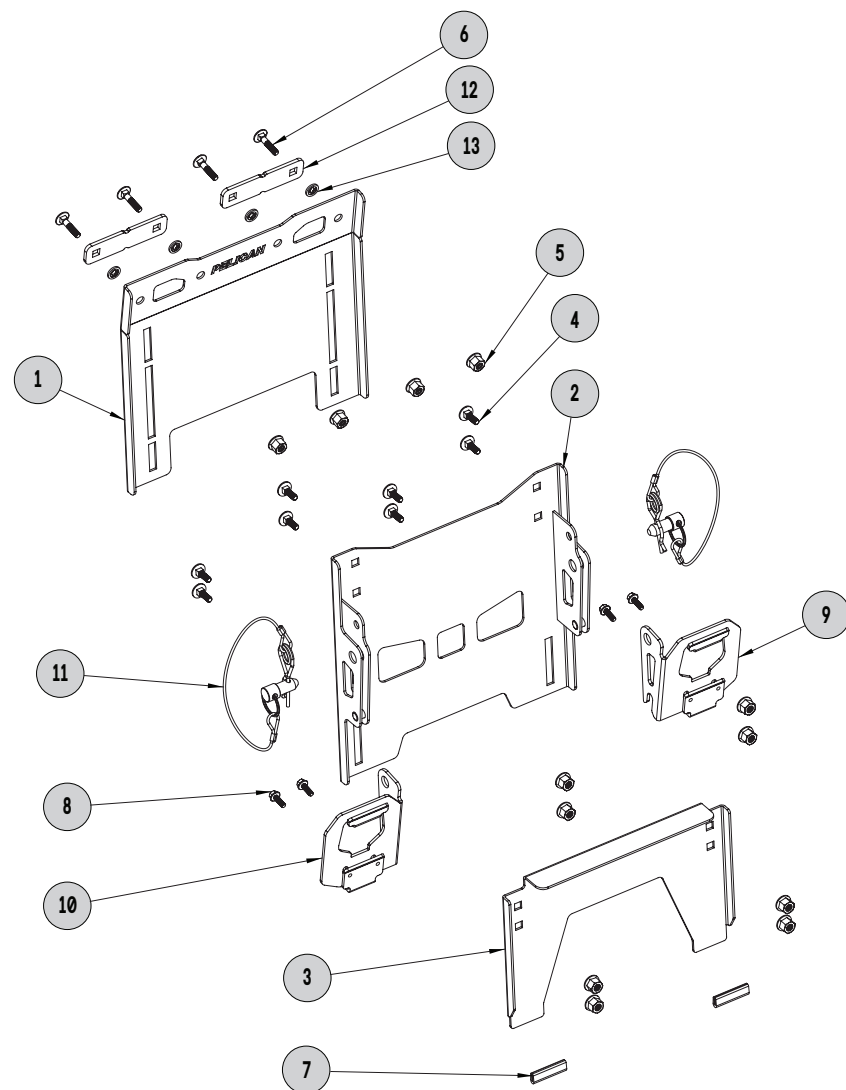

3 UPPER AND LOWER MOUNTS ASSEMBLY

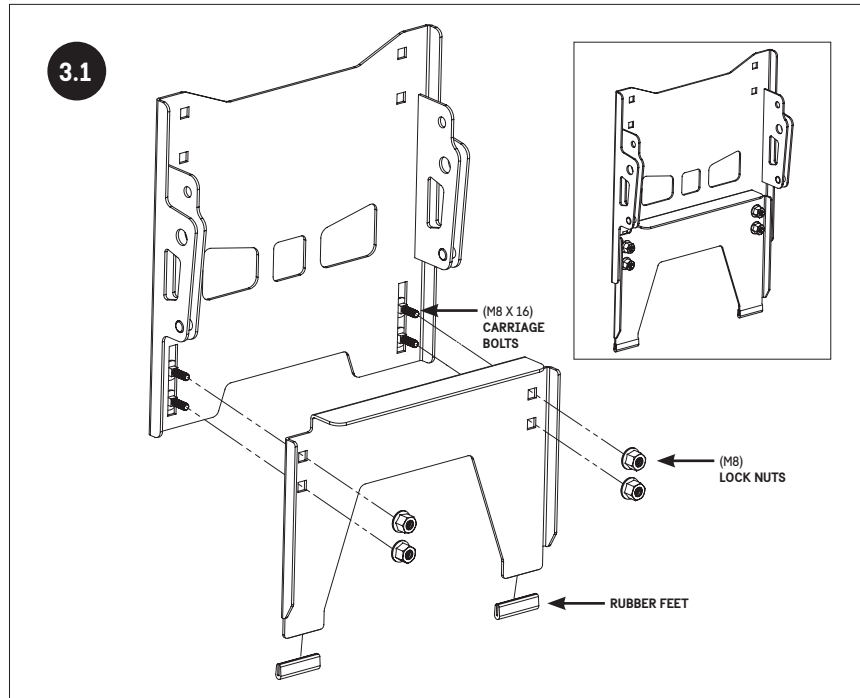

FIT FOUR (M8 X 16) CARRIAGE BOLTS THROUGH SLOTS IN LOWER MOUNT TO ASSEMBLE FOOT PLATE WITH (M8) LOCK NUTS. TIGHTEN PARTIALLY, TO ALLOW SLIDING OF FOOT FOR LATER ADJUSTMENT. PUSH ON TWO RUBBER FEET SNUGLY AS SHOWN.

4 PRELIMINARY MOUNTING TO CASE CLAMPS

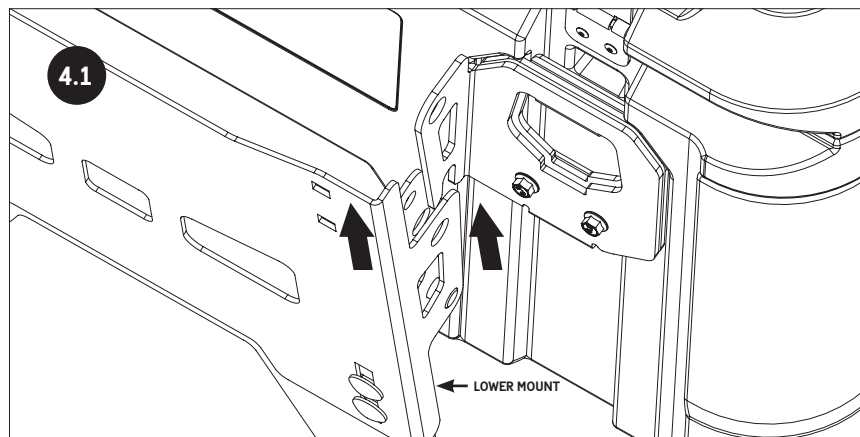

SLIDE LOWER MOUNT UP TO ENGAGE FIXED BOTTOM PINS IN EARHOOKS ON CASE CLAMPS.

NOTE: BX80 CASE SHOWN; IF MOUNTING BX50 CUBE, THE CLAMP EARS WILL BE OUTBOARD.

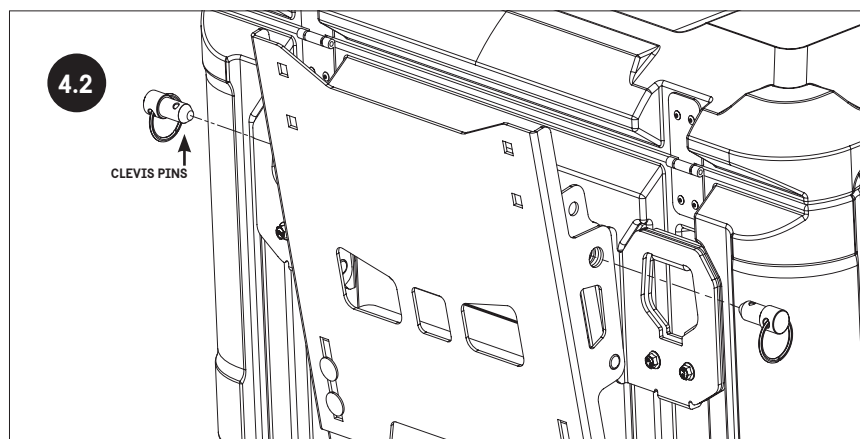

EAR-HOOK ENGAGEMENT WITH MOUNTING PINS.

SECURE BY FITTING TWO CLEVIS PINS THRU HOLES ON BOTH SIDES AS SHOWN.

5 FIT & SECURE

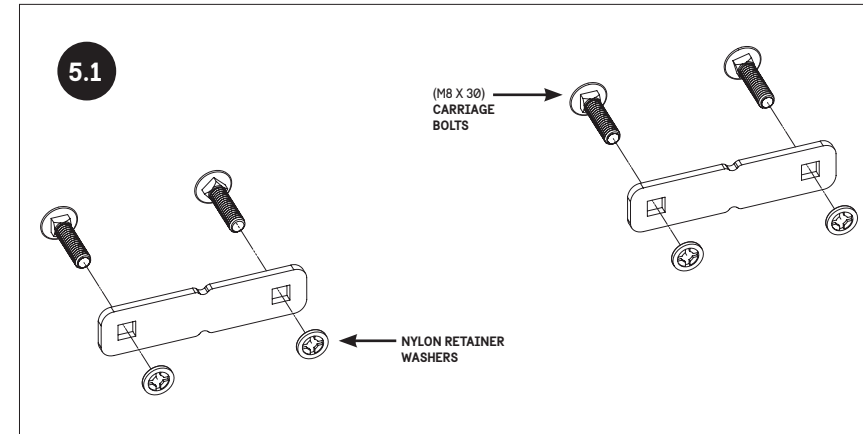

ASSEMBLE FOUR (M8 X 30) CARRIAGE BOLTS THROUGH SLOTS IN NUT PLATES TO NYLON RETAINER WASHERS.

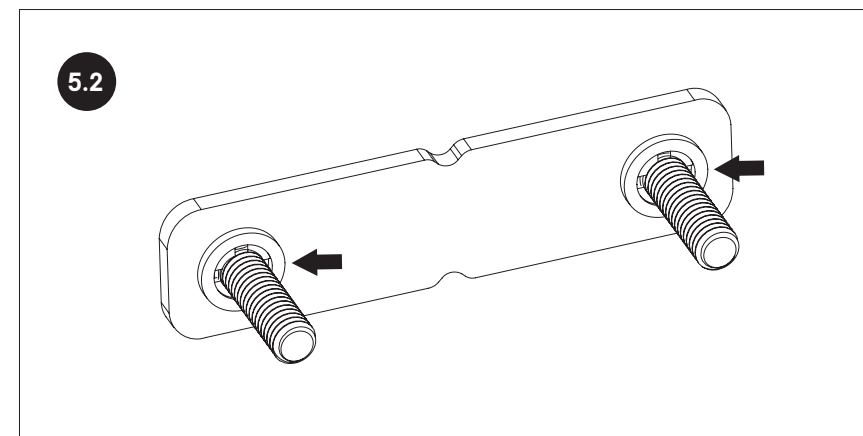

SLIDE NYLON RETAINER WASHERS FIRMLY AGAINST NUT PLATES TO TIGHTLY SEAT SQUARE BOLT FEATURES IN SLOTS AS SHOWN.

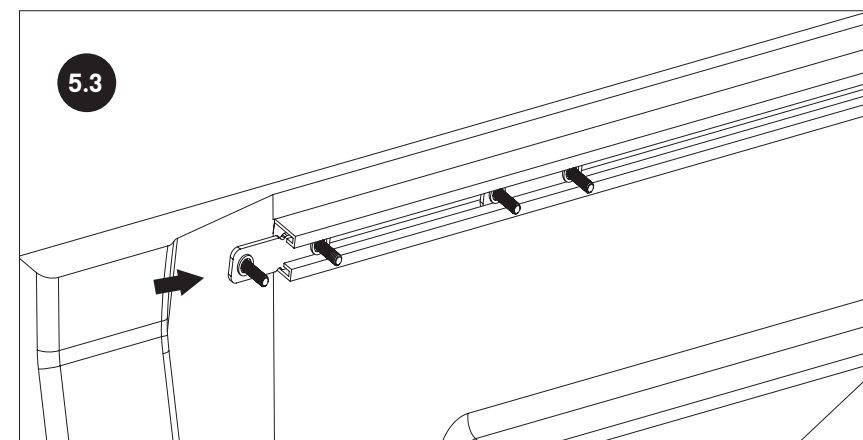

SLIDE PAIR OF NUT PLATE ASSEMBLIES INTO BED RAIL.

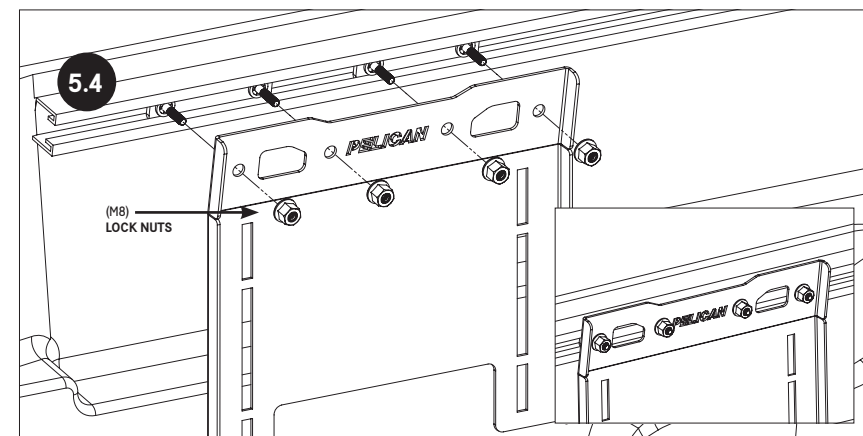

FIT UPPER MOUNT TO STUD PLATE ASSEMBLIES USING 4 (M8) LOCK NUTS.

DO NOT TIGHTEN NUTS FULLY. ALLOW SLIDING ON RAIL FOR FINAL CASE POSITIONING.

5 FIT & SECURE

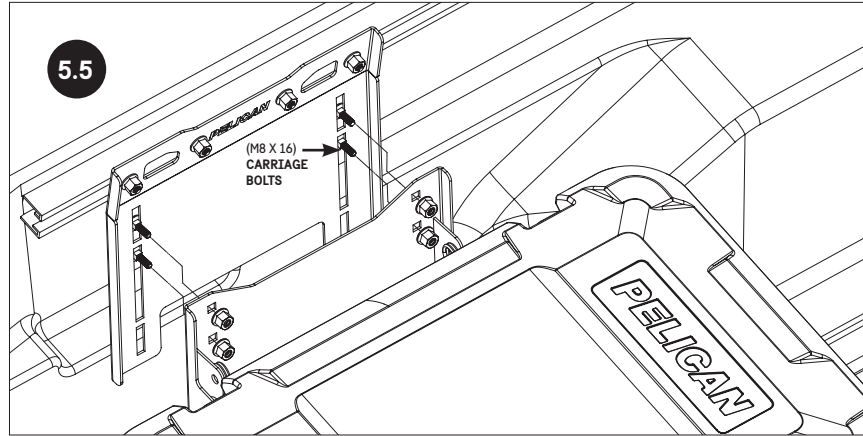

WITH LOWER MOUNT PINNED TO THE CASE, PLACE ASSEMBLY INTO TRUCK BED. ALIGN UPPER AND LOWER MOUNTING PLATES.

FIT FOUR (M8 X 16) CARRIAGE BOLTS TO APPROPRIATE SLOTS TO LINE UP WITH HOLES ON LOWER MOUNT.

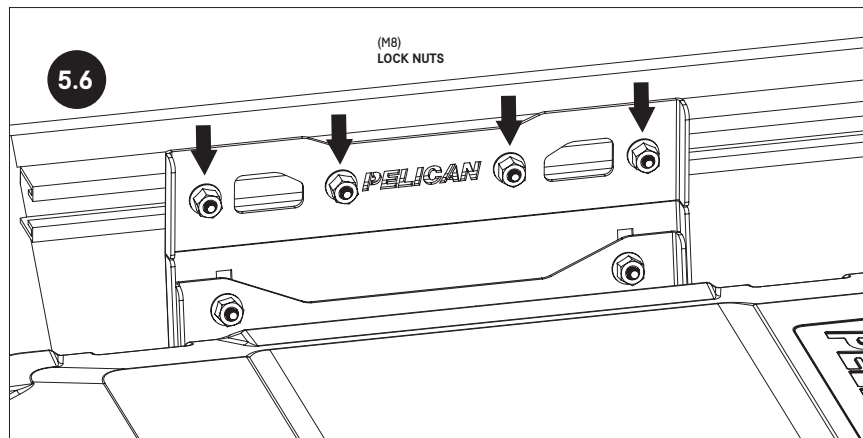

IMPORTANT: CLEVIS PINS ARE TO BE KEPT IN PLACE FOR THIS NEXT TIGHTENING STEP:

FASTEN (M8) LOCK NUTS AND FULLY TIGHTEN TO SECURE UPPER AND LOWER MOUNTS.

CHECK FINAL LOCATION ALONG RAIL IN BED THEN FULLY TIGHTEN FOUR (M8) LOCK NUTS.

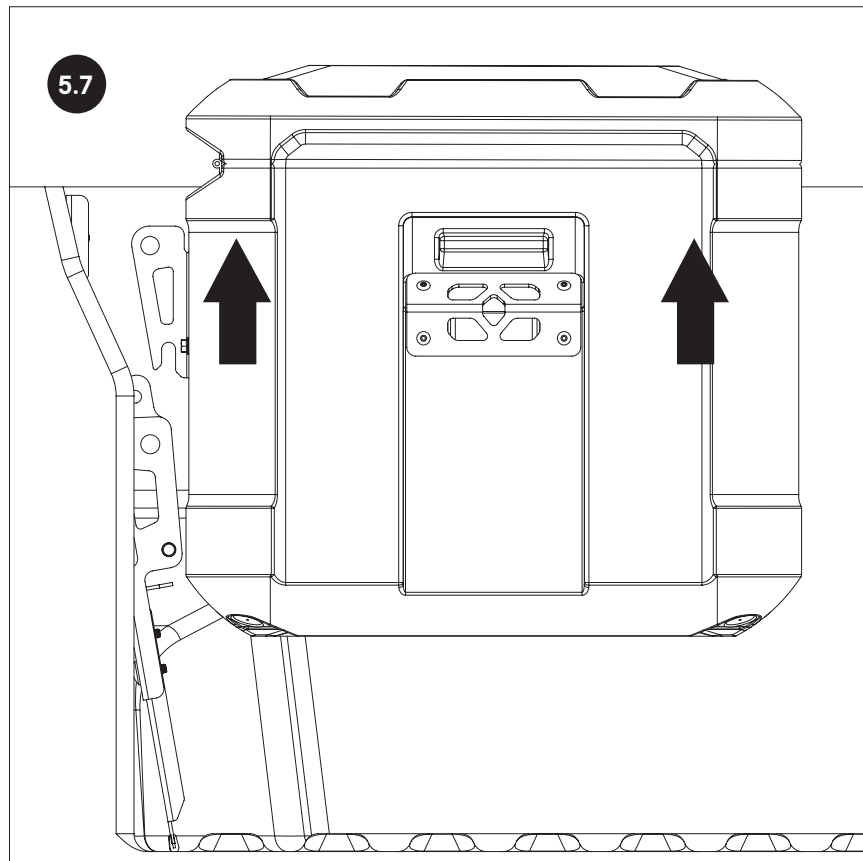

REMOVE TWO CLEVIS PINS AND LIFT CASE UP AND OUT OF WAY TO ALLOW ACCESS TO FOOT PLATE FOR FINAL ADJUSTMENT.

2 CASE PLATE CLAMP INSTALLATION

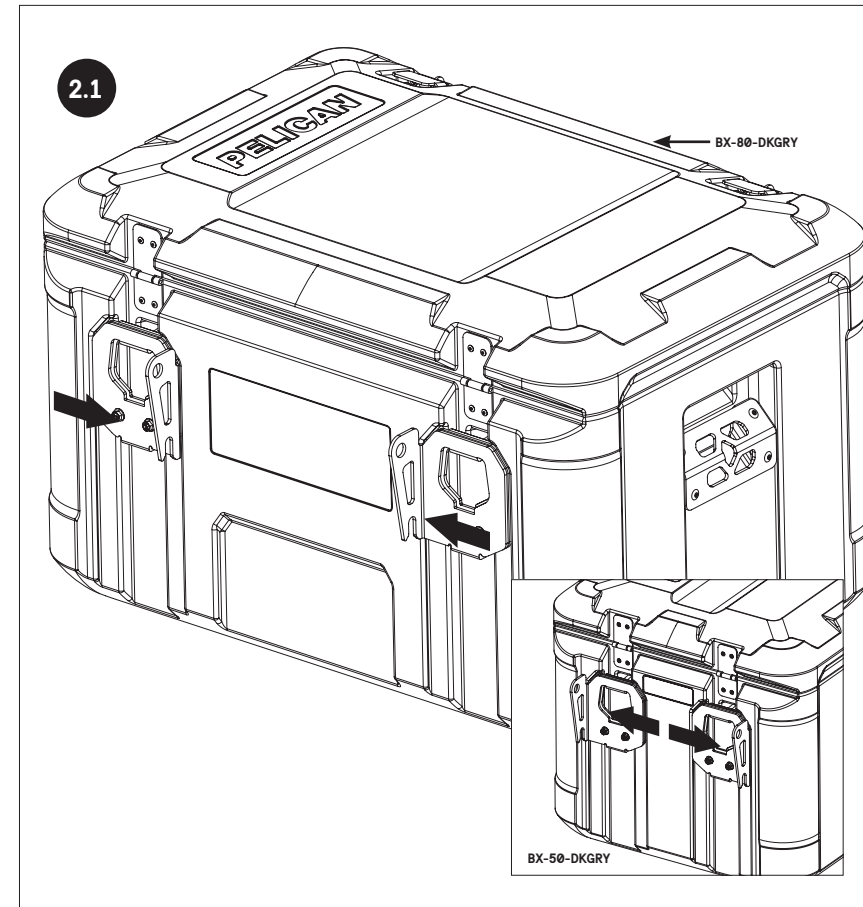

IMPORTANT: FOR BX80 SMALL CARGO CASE (CARGO BX-80-DKGRY) BRACKET

INSTALL CLAMPS A&B TO TIEDOWN PLATES ON SMALL CASE/CUBE.

IF LID IS TO BE OPENED AND ACCESSED FROM OUTSIDE OF TRUCK BED, MOUNT CLAMPS ON SAME SIDE AS LATCHES.

IF LID IS TO BE OPENED AND ACCESSED FROM INSIDE OF TRUCK BED, MOUNT CLAMPS ON SAME SIDE AS HINGES (AS SHOWN).

IMPORTANT: FOR BX50 SMALL CARGO CASE, TRUNK (CARGO BX-50-DKGRY) BRACKET

FOR CUBE CASE (CARGO BX-50-DKGRY BX50), BRACKETS MUST FACE OUTWARDS AS SHOWN.

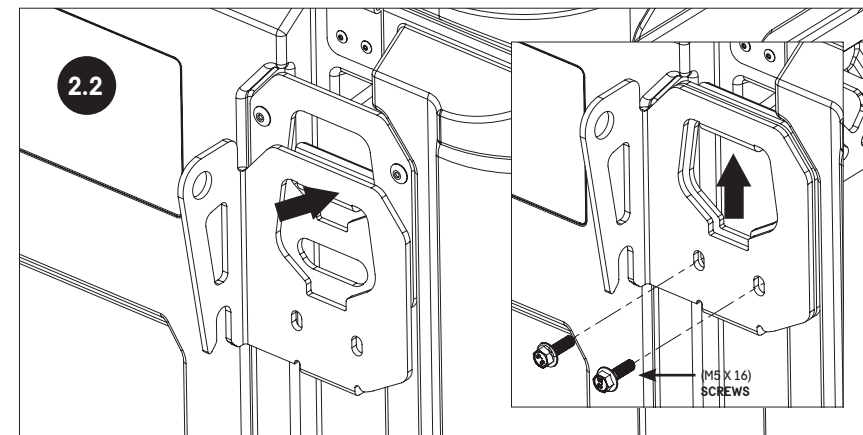

SLIDE CLAMP UPWARDS WITH HOOKS INSERTED IN TOP SLOT AND ON BOTTOM EDGE OF TIEDOWN PLATE.

CENTER CLAMP LEFT TO RIGHT ON PLATE TO ALIGN SCREW HOLES WITH PLATE SLOT.

FIT (M5 X 16) SCREWS THROUGH SLOTS INTO THREADED HOLES ON CLAMP REAR WALL.

KEEP CLAMP VERTICAL AS SHOWN WHILE TIGHTENING SCREWS TO FIRMLY CLAMP ON TIEDOWN PLATE.

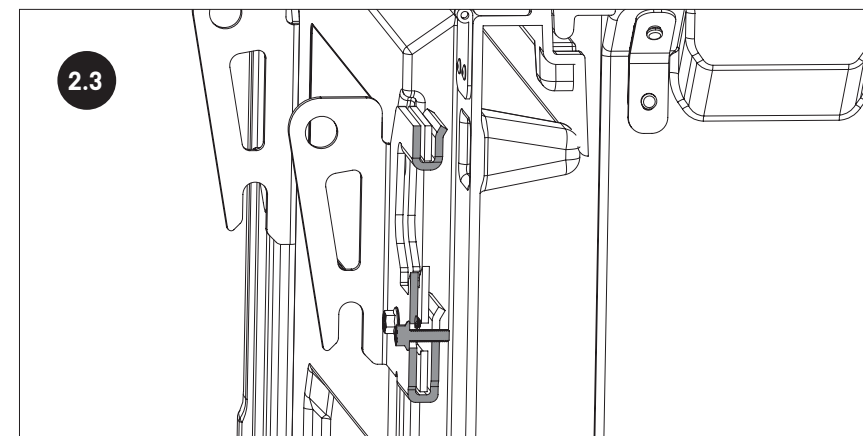

CLAMP SHOULD BE SECURE AGAINST SLIDING OR ROTATION, WITH MOUNTING EAR VERTICAL.

REPEAT INSTALLATION FOR OTHER CLAMP.