

CROSS-BED MOUNTING KIT

TOYOTA™ RAIL

SINCE 1976



CARGO CROSS-BED MOUNTING KIT

TOYOTA™ RAIL

SINCE 1976



PELICAN™ CARGO CASES AND MOUNTS LIMITED LIFETIME WARRANTY (CASES) AND THREE YEAR WARRANTY (MOUNTS)

Pelican Products, Inc. (“Pelican”) guarantees its Pelican™ Cargo cases for a lifetime against breakage or defects in workmanship. This lifetime warranty does not cover mounting hardware, which Pelican warrants against defects in materials and workmanship for three years from the date of purchase. To the extent permitted by law, Pelican’s liability is limited to the case and not its contents and in no event shall Pelican’s liability to the purchaser for damages exceed the purchase price of the case in respect of which damages are claimed.

TO THE EXTENT PERMITTED BY LAW: (A) THIS WARRANTY IS IN LIEU OF ALL WARRANTIES, EXPRESS OR IMPLIED, INCLUDING, BUT NOT LIMITED TO, THE IMPLIED WARRANTIES OF MERCHANTABILITY AND FITNESS FOR A PARTICULAR PURPOSE; (B) ALL OTHER IMPLIED WARRANTIES AND ANY LIABILITY NOT BASED UPON CONTRACT ARE HEREBY DISCLAIMED AND EXCLUDED; AND (C) IN NO EVENT SHALL PELICAN BE LIABLE FOR ANY INDIRECT, PUNITIVE, INCIDENTAL OR CONSEQUENTIAL DAMAGES, OR SPECIAL DAMAGES, REGARDLESS OF WHETHER A CLAIM FOR SUCH DAMAGES IS BASED ON WARRANTY, CONTRACT, NEGLIGENCE OR OTHERWISE .

With valid dated proof of purchase, Pelican will either repair or replace any broken or defective product, at our sole option. Certain products are available for a limited time only. If a claim is made involving one of these products, Pelican reserves the right to replace a broken or defective product with a standard Pelican product of comparable size and quality if no comparable limited edition product is available at the time of a claim. TO THE EXTENT PERMITTED BY LAW, THIS SHALL BE THE SOLE AND EXCLUSIVE REMEDY OF THE PURCHASER.

To make a warranty claim, the purchaser must complete the warranty claim form at <https://www.pelican.com/us/en/support/warranty/>. Any warranty claims shall be made by the purchaser as soon as practicable and, with respect to the mounts and related hardware, no later than three years from the date of purchase. The purchaser must provide valid dated proof of purchase and obtain a return authorization number from Pelican Customer Service prior to returning any product, and is responsible for paying for all warranty freight costs. If Pelican determines that any returned product is not defective, within the terms of this warranty, the purchaser shall pay Pelican all costs of handling, return freight and repairs at Pelican's prevailing rates.

This warranty does not cover normal wear and tear including but not limited to scratches, dents or tears, aesthetic surface damage which may be caused by oxidation or by the natural breakdown of colors caused by exposure to the elements. All warranty claims of any nature are barred if the product has been altered, damaged or in any way physically changed, or subjected to abuse, misuse, negligence or accident.

Some states and countries do not allow limitations on how long an implied warranty lasts or the exclusion or limitation of incidental or consequential damages, so the above limitation or exclusion may not apply to you. This warranty gives you specific legal rights, and you may have other rights which vary from state to state and country to country.

In Australia: The benefits provided to you under this warranty are in addition to your rights and remedies as a consumer under the Australian Consumer Law as contained in the Competition and Consumer Act 2010 (Cth) (“the Act”). Nothing in this warranty limits the rights or obligations of a party under the Act in relation to the supply to consumers of goods which cannot be limited, modified or excluded. If applicable, our goods come with guarantees that cannot be excluded under the Act. Consumers are entitled to a replacement or refund for a major failure and compensation for any other reasonably foreseeable loss or damage. Consumers are also entitled to have the goods repaired or replaced if the goods fail to be of acceptable quality and the failure does not amount to a major failure. If you are not a consumer under the Act, then your rights may be limited. To make a warranty claim, the purchaser may contact Pelican Products Australia, Suite 2.33, West Wing, Platinum Bldg., Erina NSW 2250, Tel: +612 4367 7022, or email: info.australia@pelican.com. Any claims should be made as soon as practicable. To expedite claims, the purchaser should obtain a return authorization number from Pelican Customer Service prior to returning any product. The purchaser is responsible for paying for all freight costs. If Pelican determines that any returned product is not defective, within the terms of this warranty or the Act, the purchaser may pay Pelican all costs of handling, return freight and repairs at Pelican's prevailing rates. In the event that Pelican determines that any returned product is defective, within the terms of this warranty or the Act, Pelican shall pay the purchaser all reasonable costs of the purchaser in making a claim under this warranty.

Lifetime warranty does not cover Vault by Pelican or Roto Molded cases or fabric portion of backpacks.

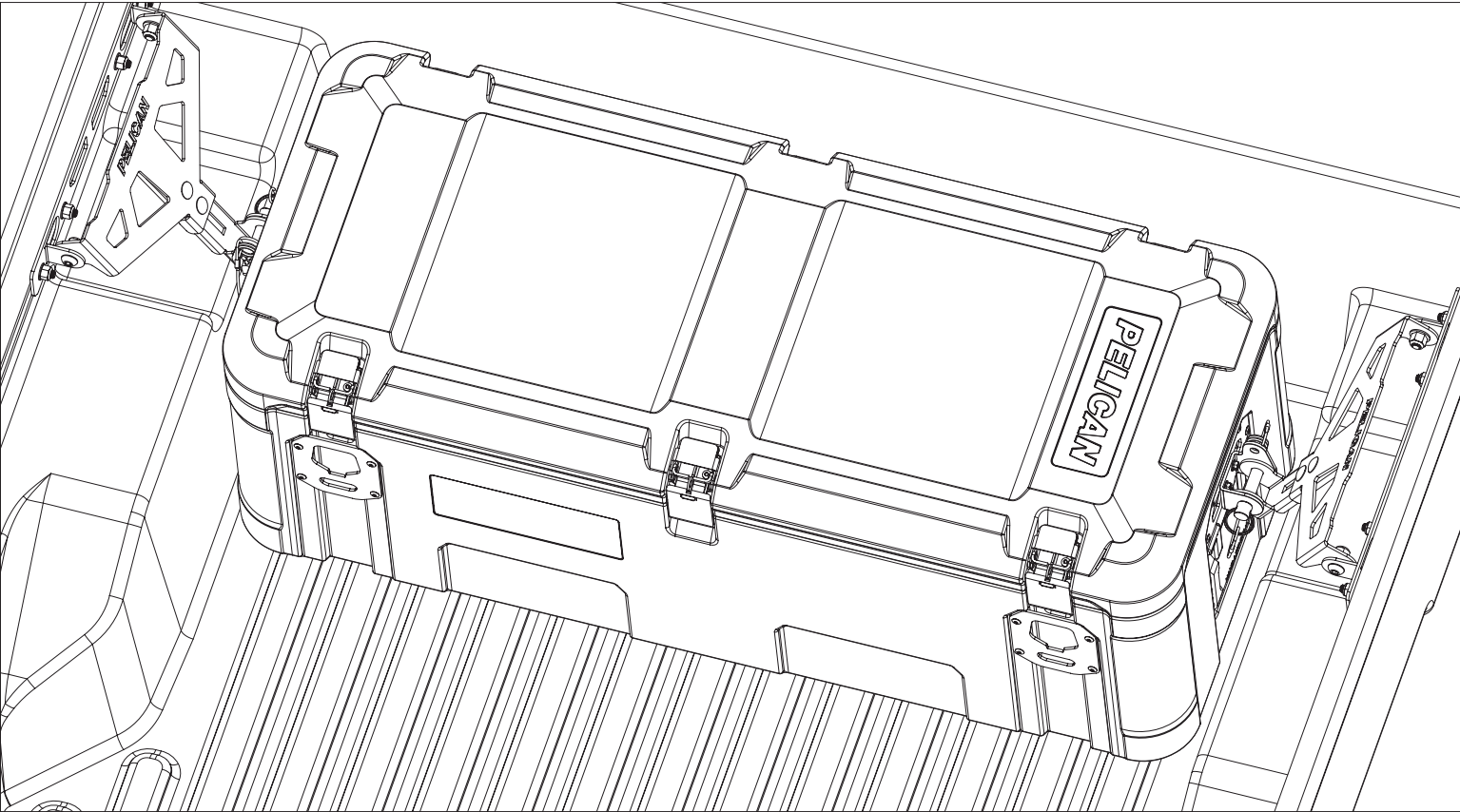

READ ME!

THANK YOU FOR PURCHASING A PELICAN™ CARGO CROSS-BED MOUNTING KIT, FOR A TOYOTA™ RAIL STYLE TRUCK BED. BEFORE YOU START, TAKE A MOMENT TO FAMILIARIZE YOURSELF WITH THE FITTING INSTRUCTIONS AND THE COMPONENTS RECEIVED. REFER TO PAGE 2 FOR A LIST OF ALL THE COMPONENTS, QUANTITIES AND TOOLS REQUIRED.

- CASE MUST BE CENTERED LEFT-TO-RIGHT IN THE PICKUP BED FOR CORRECT AND SECURE MOUNTING, AND REQUIRES BOTH MOUNTS.
- CASE IS USUALLY PLACED AT FRONT OF BED NEAR WALL, BUT MAY BE POSITIONED WHERE DESIRED, AS BED RAILS AND WHEEL-WELLS PERMIT.
- CHECK THAT POSITION OF CASE ALLOWS OPENING OF LID WITHOUT INTERFERENCE.
- CHECK THAT CASE POSITION WITH OPEN LID DOES NOT ALLOW CONTACT BETWEEN CASE LATCHES AND REAR WINDOW.



IMPORTANT WARNING!

It is critical that the Pelican™ Cargo Mounts and Cases be properly installed and securely attached to your vehicle. Failure to properly secure the mounts and cases to your vehicle could result in serious injury and even death. You are responsible for the fitment of the mounts and Cargo Cases to your vehicle. You must therefore periodically inspect the equipment for wear and damage. Replace if in doubt. If you have limited mechanical experience you should not attempt to install the equipment. You should have the equipment installed by a professional installer if you have any doubts about your abilities.

It is imperative that the user check the security of the cases to the vehicle after an initial brief period of driving and adjust if required. Pelican recommends the user do so periodically and, if road conditions change (i.e. freeway to dirt road) again check the security of the attachment of the Case to the vehicle.



LATCHES AND MOUNTING KIT CARE

Periodically check the latches and mounting hardware to ensure there are no loose parts. Continual exposure to daylight may cause the black hardware finish to dull. To maintain the gloss finish, occasionally apply a light coat of UV protectant. After exposure to salty coastal climates or snowy regions, rinse off the mounts with water to remove salt deposits. To help prevent corrosion, apply a silicone-based oil or spray to nuts and bolts.

1 GET ORGANIZED

PARTS LIST

ITEM NO.	DESCRIPTION	QTY.
1	MOUNTING BRACKET	2
2	UPPER MOUNT	2
3	(M10 X 25) SCREW	4
4	(M10) LOCK NUT	4
5	CASE PLATE CLAMP	2
6	TETHERED PIN & R-CLIP ASSY	2
7	(M5 X 16) SCREW	4
8	(M8) LOCK NUT	12
9	(M8 X 16) CARRIAGE BOLT	4
10	(M8 X 30) CARRIAGE BOLT	8
11	LOWER MOUNT	2
12	NUT PLATE	4
13	NYLON RETAINER WASHER	8
14	(M10) NYLON FLAT WASHER	4

TOOLS NEEDED*

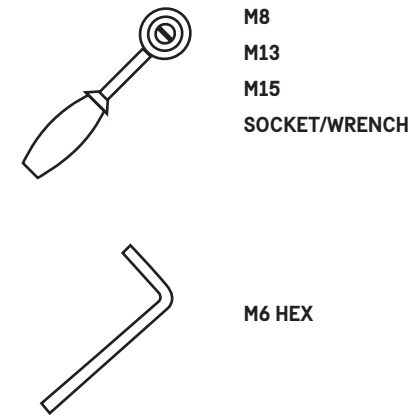

* Tools not included.

4 FIT & SECURE

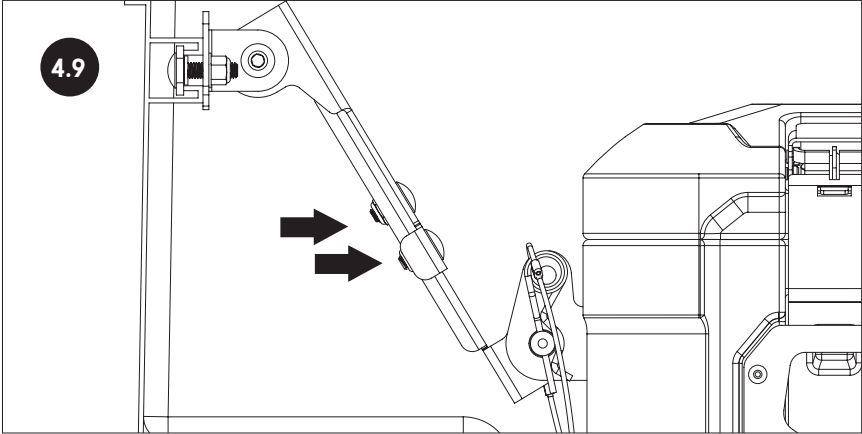

REPEAT WITH INSTALLATION OF MOUNT ON OPPOSITE SIDE OF CASE AND TRUCK BED.

MAKE SURE CASE IS CENTERED LEFT-TO-RIGHT IN TRUCK BED, THEN FIRMLY TIGHTEN LOCK-NUTS ON BOTH LOWER MOUNTS.

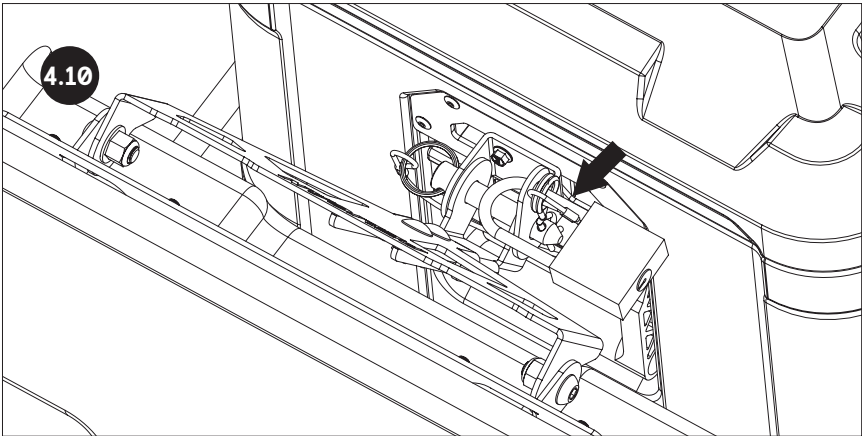

FOR THEFT PREVENTION, SECURE R-CLIP TO CASE CLAMP WITH PADLOCK (NOT INCLUDED) ON ONE OR BOTH SIDES OF CASE.

5 INSTALLATION COMPLETE

YOUR NEW PELICAN™ CARGO CASE IS NOW SECURED WITH CROSS-BED MOUNTING.

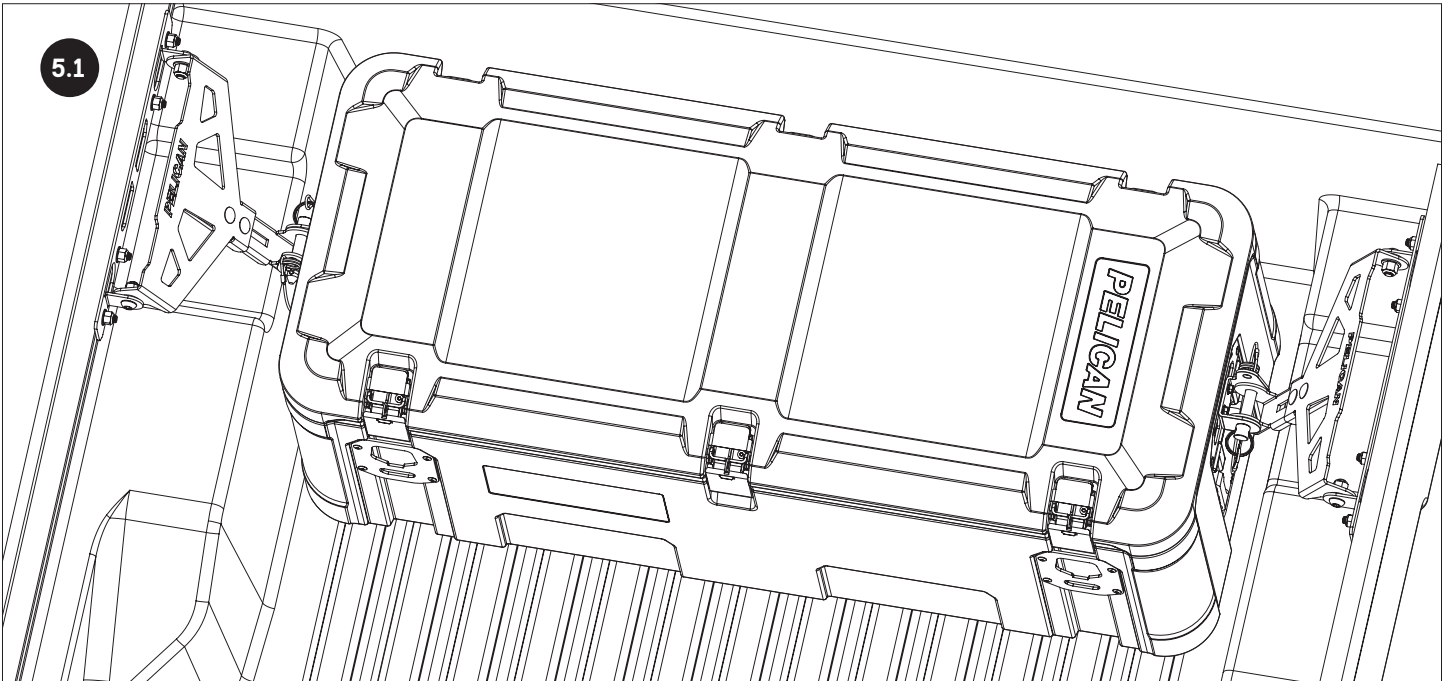

1.1

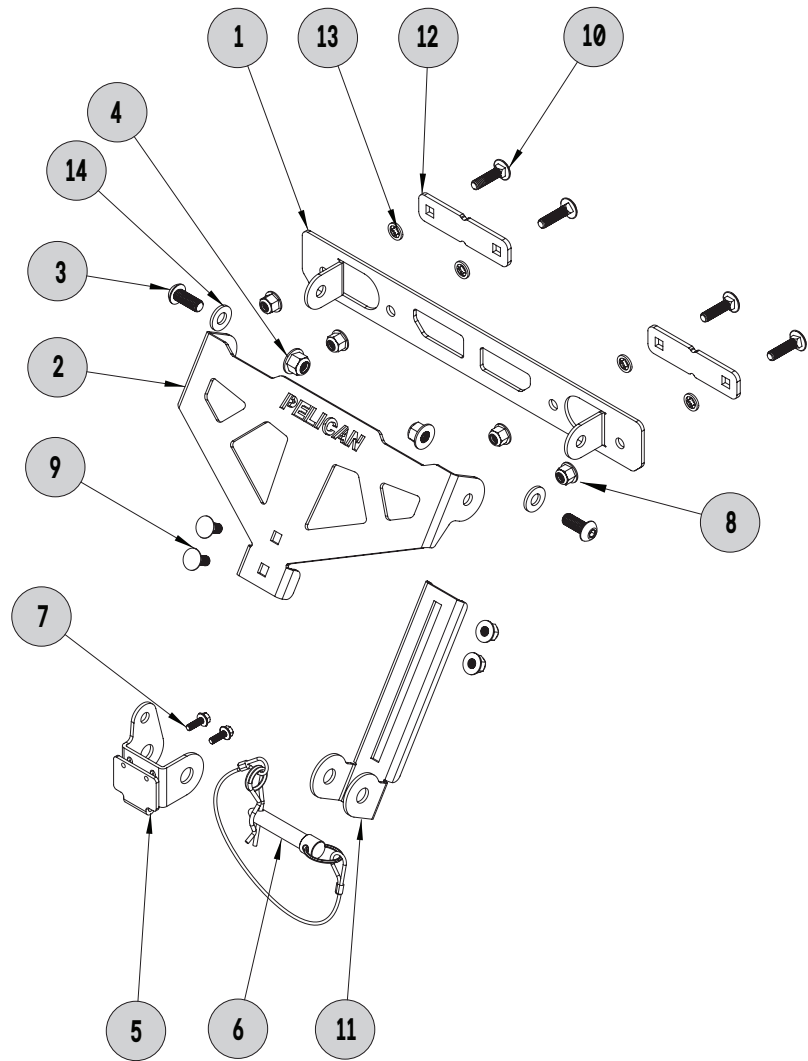

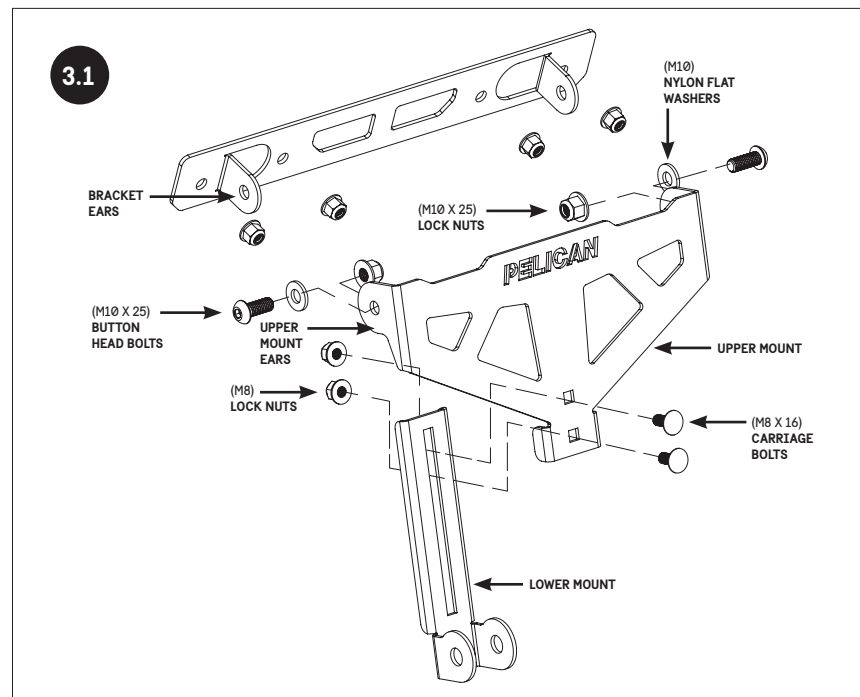

ASSEMBLE UPPER AND LOWER MOUNTS TO BRACKETS

FIT TWO (M8 X 16) CARRIAGE BOLTS IN SQUARE HOLES FROM TOP OF UPPER MOUNT THROUGH SLOT IN LOWER MOUNT. FASTEN (M8) LOCK NUTS LOOSELY TO ALLOW SLIDING ADJUSTMENT LATER.

PLACE EARS OF UPPER MOUNT BETWEEN BRACKET EARS, WITH (M10) NYLON FLAT WASHERS BETWEEN METAL EAR SURFACES. FIT (M10 X 25) BUTTON HEAD BOLTS.

FASTEN (M10) LOCK-NUTS SNUGLY BUT STILL PERMITTING ROTATION OF MOUNT. THIS ALLOWS SWINGING OF MOUNTS OUT OF WAY WHEN INSTALLING/REMOVING CASE FROM TRUCK.

REPEAT FOR SECOND MOUNT ASSEMBLY.

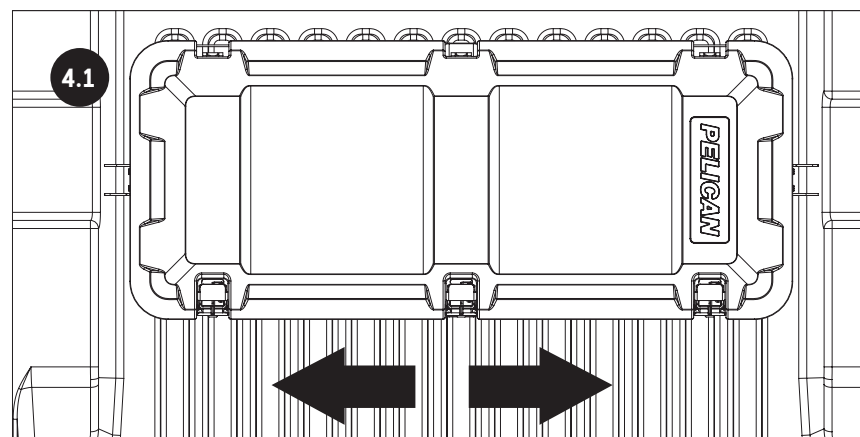

PLACE CASE IN DESIRED TRUCK BED LOCATION TO DETERMINE LOCATION OF MOUNTING BRACKETS.

IMPORTANT: CASE MUST BE CENTERED LEFT TO RIGHT TO PROPERLY SECURE CASE WITH CROSS-BED MOUNTING SYSTEM.

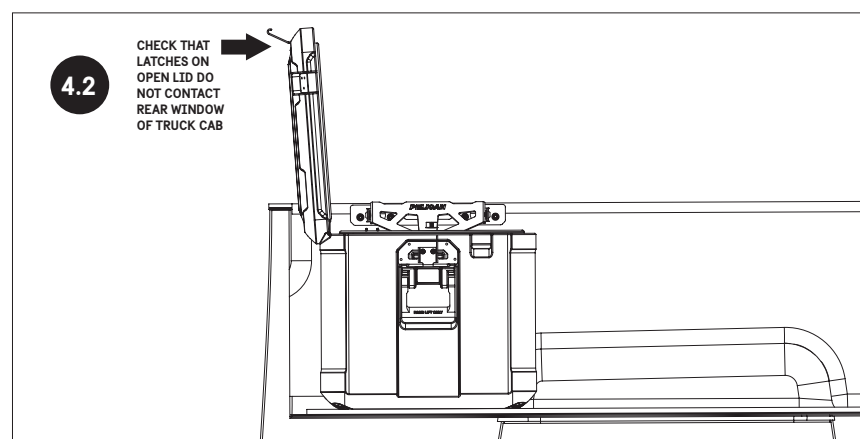

ENSURE ADEQUATE CLEARANCE FOR LID OPENING. CHECK THAT LATCHES ON OPEN LID DO NOT CONTACT REAR WINDOW OF TRUCK CAB.

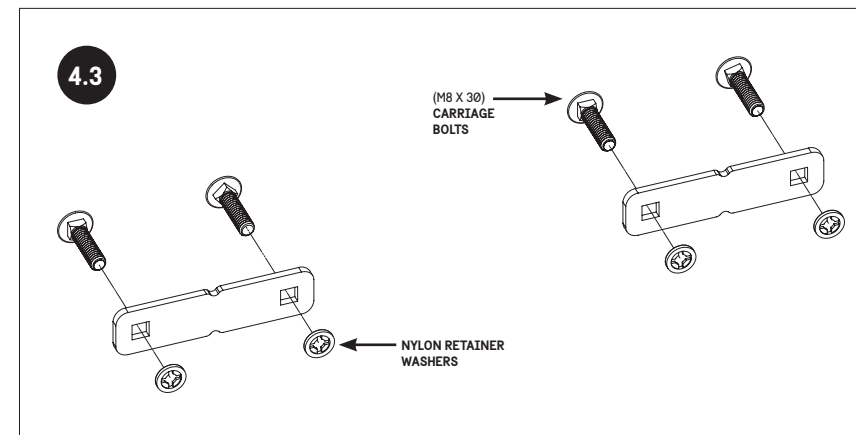

ASSEMBLE FOUR (M8 X 30) CARRIAGE BOLTS THROUGH SLOTS IN NUT PLATES TO NYLON RETAINER WASHERS.

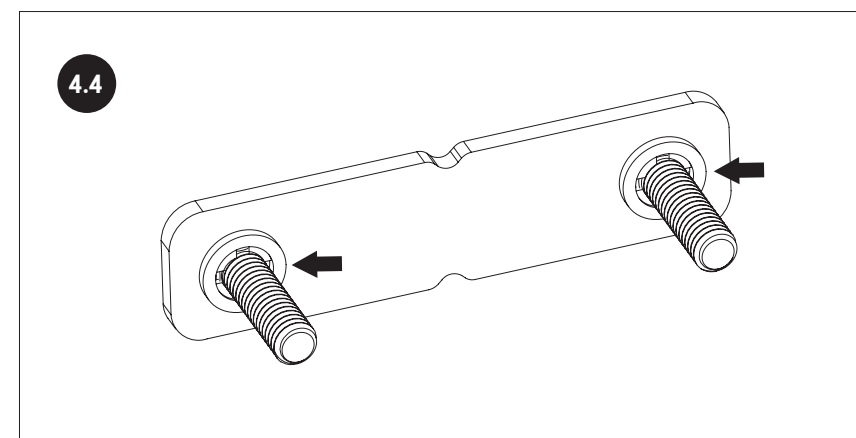

SLIDE NYLON RETAINER WASHERS FIRMLY AGAINST NUT PLATES TO TIGHTLY SEAT SQUARE BOLT FEATURES IN SLOTS AS SHOWN.

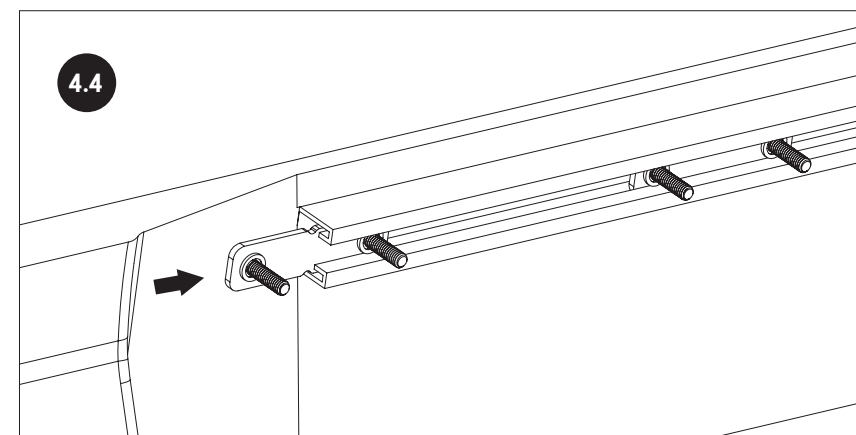

SLIDE PAIR OF NUT PLATE ASSEMBLIES INTO BED RAIL.

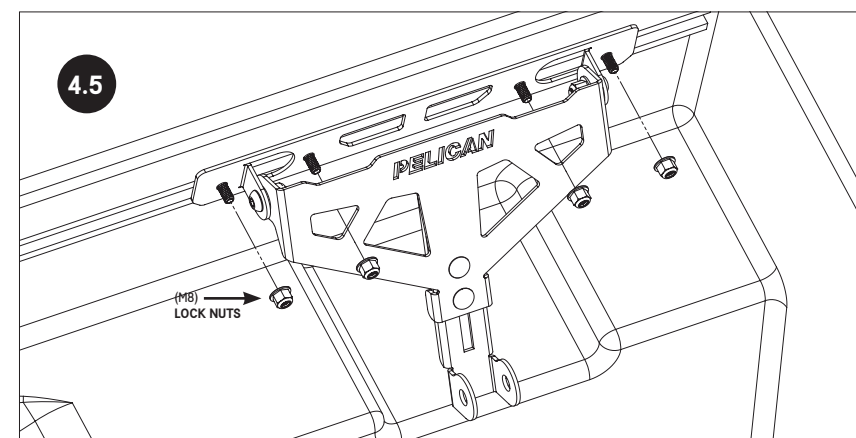

POSITION NUT PLATES TO LINE UP WITH MOUNT ASSEMBLY AND FIT FOUR (M8) LOCK-NUTS. PARTIALLY TIGHTEN NUTS TO ALLOW SLIDING ADJUSTMENT WITH CASE POSITION AND OPPOSITE MOUNT ASSEMBLY.

REPEAT WITH INSTALLATION OF MOUNT ON OPPOSITE SIDE OF CASE AND TRUCK BED.

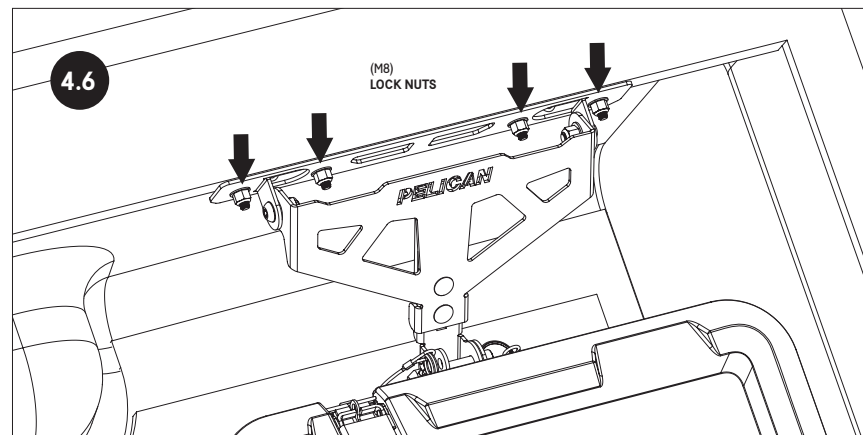

MAKE FINAL CHECK THAT CASE IS IN DESIRED LOCATION AND HAS SUFFICIENT CLEARANCE TO BED WALL/CAB WINDOW FOR SAFE LID OPENING..

FIRMLY TIGHTEN THE FOUR (M8) LOCK-NUTS ON RAIL MOUNT TO SECURE POSITION.

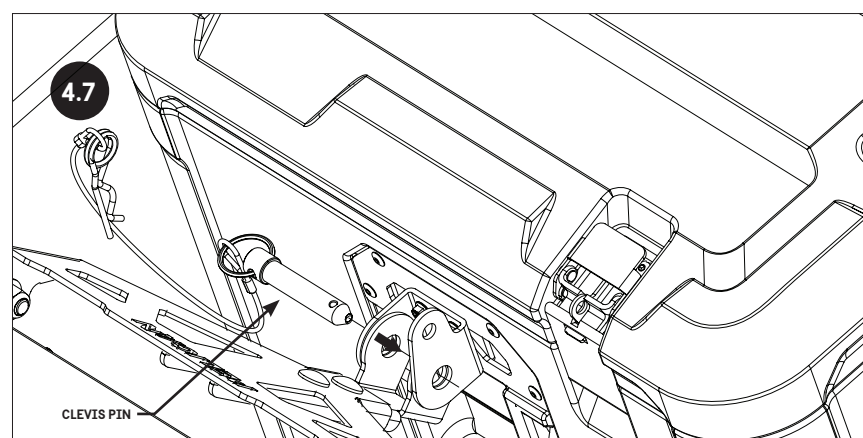

SWING MOUNT UPWARDS BETWEEN CASE CLAMP EARS, AND ADJUST LOWER MOUNT LENGTH TO INSERT CLEVIS PIN THROUGH BOTH PARTS.

HOLE IN END OF CLEVIS PIN SHOULD END UP VERTICAL AND ON SAME SIDE OF CASE CLAMP AS PADLOCK HOLE.

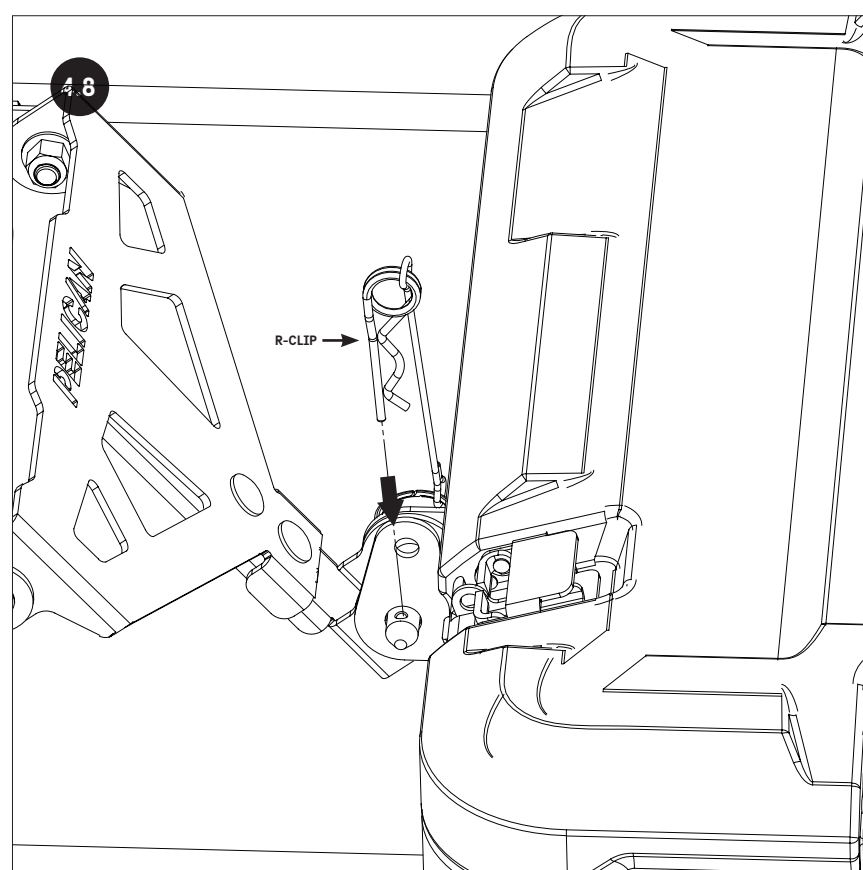

INSERT R-CLIP AS SHOWN TO SECURE CLEVIS PIN.

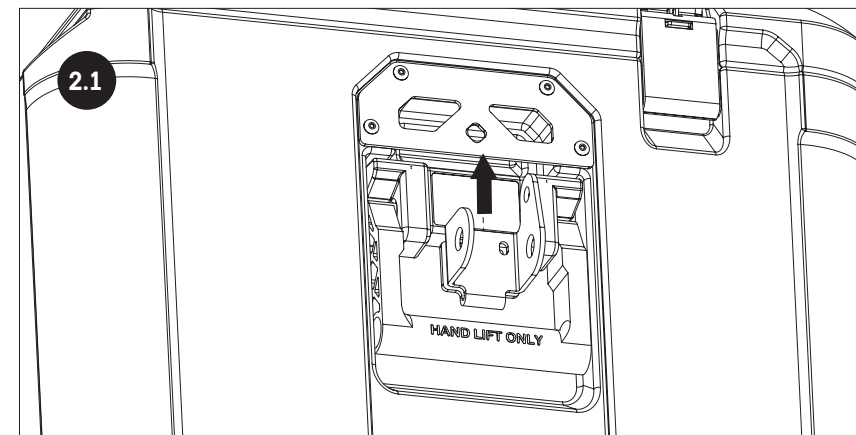

INSTALL CASE PLATE CLAMP TO TIEDOWN PLATE.

SLIDE CASE PLATE CLAMP UPWARDS ON TIEDOWN PLATE SO U-SHAPED SLOT ENCLOSES PLATE.

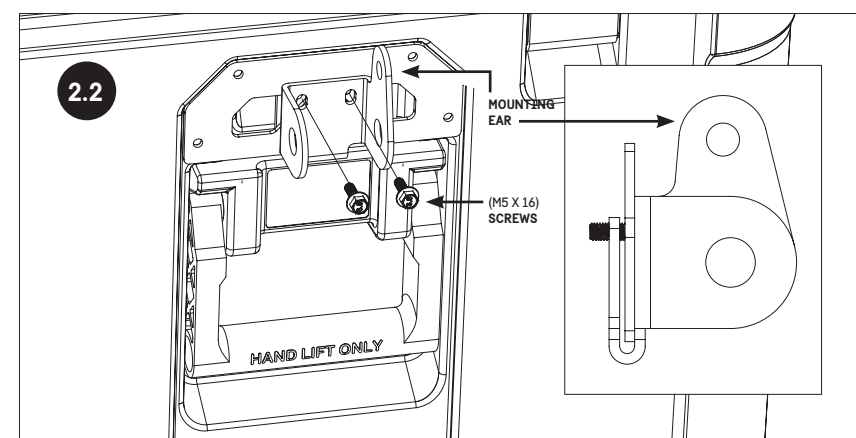

CENTER CLAMP LEFT TO RIGHT TO ALIGN SCREW HOLES WITH PLATE SLOTS.

FIT TWO (M5 X 16) SCREWS THROUGH SLOTS INTO THREADED HOLES AT REAR WALL OF CLAMP.

KEEP CLAMP VERTICAL AS SHOWN WHILE TIGHTENING SCREWS TO FIRMLY SECURE IN PLACE.

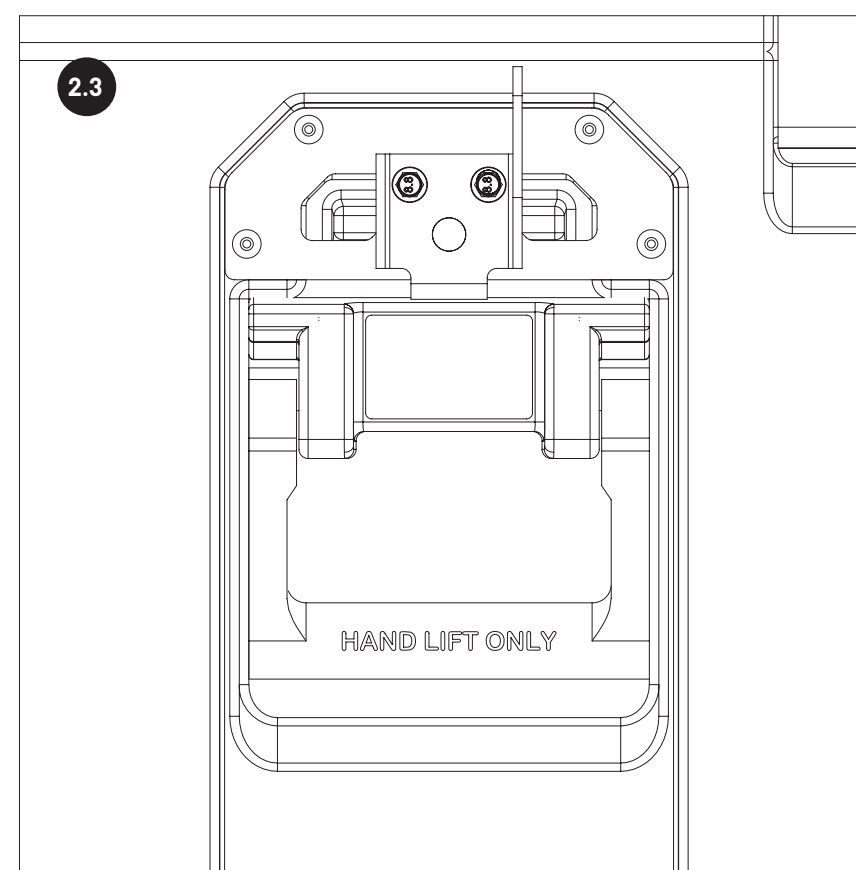

CLAMP SHOULD BE SECURE AGAINST SLIDING OR ROTATION, WITH MOUNTING EARS VERTICAL.

CHECK THAT TOP EDGE OF CLAMP IS PARALLEL WITH EDGE OF TIEDOWN PLATE.

REPEAT CASE PLATE CLAMP INSTALLATION ON OPPOSITE SIDE OF TRUNK CASE.